

Beet 11001 der Hauptwache

Altes Neuland Frankfurt

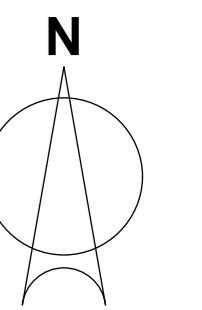
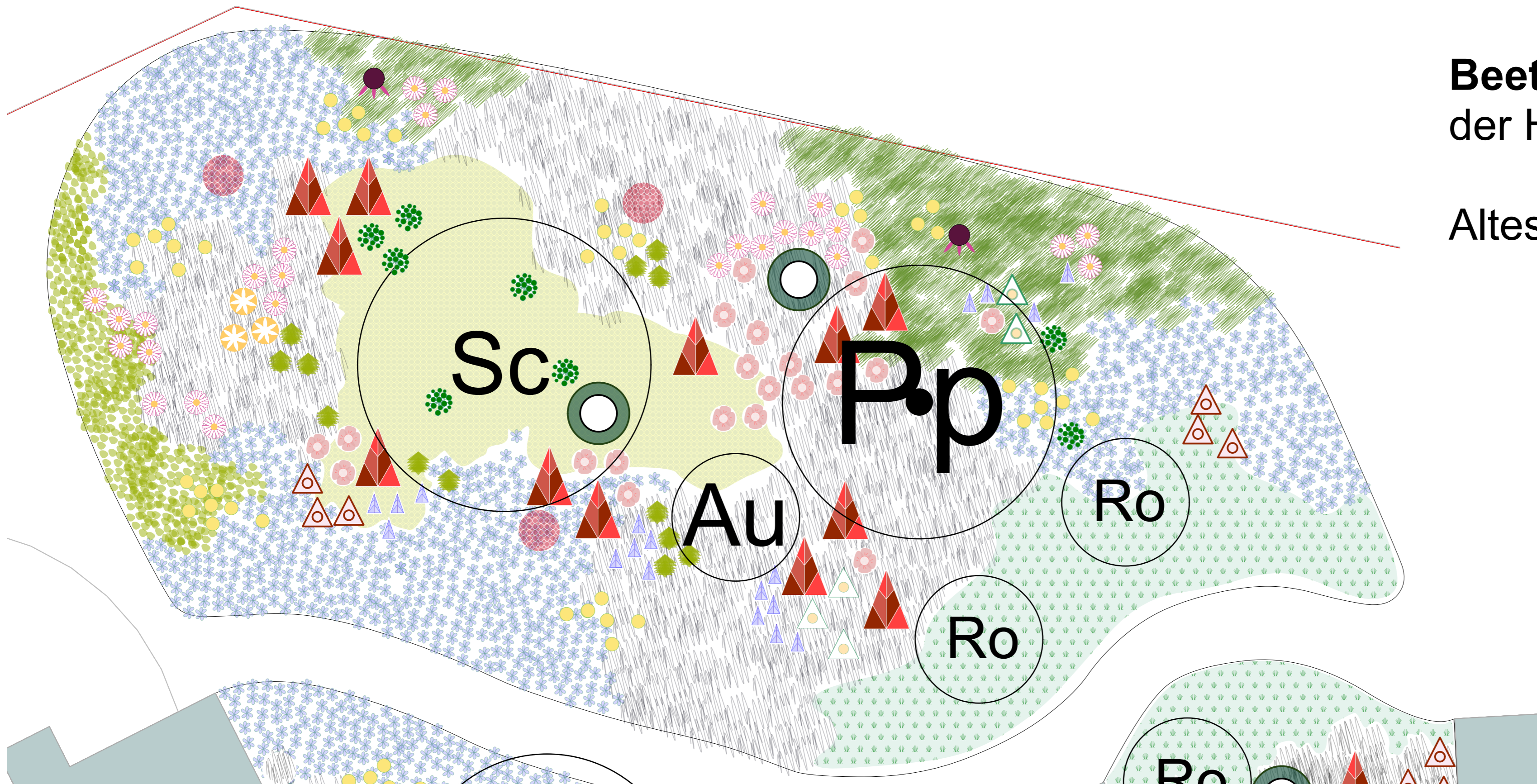

M 1:50

Matrixarten

	<i>Alchemilla epipsila</i>	II-IV	11/m ² <-> 30 cm
	<i>Epimedium pin. ssp. 'Colchicum'</i>	II-III	11/m ² <-> 30 cm
	<i>Geranium gracile-Hybride 'Sirak'</i>	II-III	8/m ² <-> 35 cm
	<i>Hakonechloa macra</i>	I	6/m ² <-> 40 cm
	<i>Sporobulus heterolepsis</i>	I	8/m ² <-> 35 cm
	<i>Liriope muscari 'Big Blue'</i>	II	16/m ² <-> 25 cm

Leitstauden

	<i>Anemone hupehensis 'Ouverture'</i>	I-II	<-> 35 cm
	<i>Aruncus sylvestris</i>	I	<-> 100 cm
	<i>Aster agerat. 'Asran'</i>	II	<-> 60 cm
	<i>Aster divaricatus</i>	I-II	<-> 60 cm
	<i>Bistorta amplex. 'JS Caliente'</i>	I	<-> 90 cm
	<i>Echinacae pallida</i>	I-II	<-> 35 cm

	<i>Erigeron cu. 'Sommerneuschnee'</i>	II	<-> 35 cm
	<i>Physostegia virg. 'Bouquet Rose'</i>	II	<-> 30 cm

Begeleitstauden

	<i>Euphorbia amyg. var. robbiae</i>	I	<-> 40 cm
	<i>Gillenia trifoliata</i>	I-II	<-> 40 cm
	<i>Primula elatior</i>	II	<-> 20 cm

Füllstaudenstauden

	<i>Campanula persicifolia 'Grandiflora Coerulea'</i>	II	<-> 30 cm
	<i>Knautia macedonica</i>	I	<-> 60 cm

Gehölze:

Au	<i>Arbutus unedo</i> , Erdbeerbaum
Pp	<i>Parrotia persica 'Vanessa'</i> , Eisenholzbaum
Ro	<i>Rhododendron oreodoxa</i> , Rhododendron
Sc	<i>Syringa x chinensis</i> , Chinesischer Flieder

